

### SS1, ST1 Series

- 超小型 • 高 CV 值 • 高度为 7mm
- SS1 型为 85°C 产品；ST1 型为 105°C 产品。
- Miniature size • High CV • 7mm height
- SS1 series for 85°C；ST1 series for 105°C.



### 主要技术性能 Specifications

使用温度范围 Operating Temperature Range	-40 ~ +85°C(SS1 series)	-40 ~ +105°C(ST1 series)																																		
额定电压范围 Rated Voltage Range	6.3 ~ 63V DC																																			
标称电容量允许偏差 Capacitance Tolerance (120Hz, 20°C)	± 20%																																			
漏电流 Leakage Rurrent	I ≤ 0.01CV(μA) 或 3 μA 取较大者, Less than 0.01CV or 3 μA Whichever is greater																																			
损耗正切角值 Dissipation Factor (120Hz 20°C)	<table border="1"> <tr> <td>W.V.</td> <td>4</td> <td>6.3</td> <td>10</td> <td>16</td> <td>25</td> <td>35</td> <td>50</td> <td>63</td> </tr> <tr> <td>tg δ</td> <td>0.35</td> <td>0.24</td> <td>0.20</td> <td>0.16</td> <td>0.14</td> <td>0.12</td> <td>0.10</td> <td>0.08</td> </tr> </table>									W.V.	4	6.3	10	16	25	35	50	63	tg δ	0.35	0.24	0.20	0.16	0.14	0.12	0.10	0.08									
W.V.	4	6.3	10	16	25	35	50	63																												
tg δ	0.35	0.24	0.20	0.16	0.14	0.12	0.10	0.08																												
温度特性 (120Hz) Temperature Characteristics Impedance Ratio (120Hz)	<table border="1"> <tr> <td>WV</td> <td>4</td> <td>6.3</td> <td>10</td> <td>16</td> <td>25</td> <td>35</td> <td>50</td> <td>63</td> </tr> <tr> <td>Z<sub>-25°C</sub> / Z<sub>+20°C</sub></td> <td>6</td> <td>4</td> <td>3</td> <td>2</td> <td>2</td> <td>2</td> <td>2</td> <td>2</td> </tr> <tr> <td>Z<sub>-40°C</sub> / Z<sub>+20°C</sub></td> <td>12</td> <td>8</td> <td>6</td> <td>4</td> <td>4</td> <td>4</td> <td>4</td> <td>4</td> </tr> </table>									WV	4	6.3	10	16	25	35	50	63	Z <sub>-25°C</sub> / Z <sub>+20°C</sub>	6	4	3	2	2	2	2	2	Z <sub>-40°C</sub> / Z <sub>+20°C</sub>	12	8	6	4	4	4	4	4
WV	4	6.3	10	16	25	35	50	63																												
Z <sub>-25°C</sub> / Z <sub>+20°C</sub>	6	4	3	2	2	2	2	2																												
Z <sub>-40°C</sub> / Z <sub>+20°C</sub>	12	8	6	4	4	4	4	4																												
耐久性 Load Life	<p>(SS1)+85°C/(ST1)+105°C施加带纹波电流的额定电压 1000 小时,恢复 16 小时后,电容器应满足下列要求 After applying rated voltage with specified ripple current for 1000 hours at(SS1) +85°C or(ST1) +105°C and then resumed 16 hours. The capacitor shall meet the following limits.</p> <table border="1"> <tr> <td>电容量变化率 Capacitance Change</td> <td>≤ ± 20% 初始测量值 ≤ ± 20% of Initial measured value</td> </tr> <tr> <td>漏电流值 Leakage</td> <td>≤ 规定值 ≤ The specified value</td> </tr> <tr> <td>损耗角正切值 Dissipation Factor</td> <td>≤ 2 倍规定值 ≤ 200% of the specified value</td> </tr> </table>									电容量变化率 Capacitance Change	≤ ± 20% 初始测量值 ≤ ± 20% of Initial measured value	漏电流值 Leakage	≤ 规定值 ≤ The specified value	损耗角正切值 Dissipation Factor	≤ 2 倍规定值 ≤ 200% of the specified value																					
电容量变化率 Capacitance Change	≤ ± 20% 初始测量值 ≤ ± 20% of Initial measured value																																			
漏电流值 Leakage	≤ 规定值 ≤ The specified value																																			
损耗角正切值 Dissipation Factor	≤ 2 倍规定值 ≤ 200% of the specified value																																			
高温贮存 Shelf Life	<p>(SS1)+85°C / (ST1)+105°C, 1000 小时, 恢复 16 小时后 After storage for 1000 hours at(SS1) +85°C or(ST1) +105°C and then resumed 16 hours</p> <table border="1"> <tr> <td>电容量变化率 Capacitance Change</td> <td>≤ ± 20% 初始测量值 ≤ ± 20% of Initial measured value</td> </tr> <tr> <td>漏电流值 Leakage</td> <td>≤ 2 倍规定值 ≤ 200% of the specified value</td> </tr> <tr> <td>损耗角正切值 Dissipation Factor</td> <td>≤ 2 倍规定值 ≤ 200% of the specified value</td> </tr> </table>									电容量变化率 Capacitance Change	≤ ± 20% 初始测量值 ≤ ± 20% of Initial measured value	漏电流值 Leakage	≤ 2 倍规定值 ≤ 200% of the specified value	损耗角正切值 Dissipation Factor	≤ 2 倍规定值 ≤ 200% of the specified value																					
电容量变化率 Capacitance Change	≤ ± 20% 初始测量值 ≤ ± 20% of Initial measured value																																			
漏电流值 Leakage	≤ 2 倍规定值 ≤ 200% of the specified value																																			
损耗角正切值 Dissipation Factor	≤ 2 倍规定值 ≤ 200% of the specified value																																			

### 外形图及尺寸 Case size table

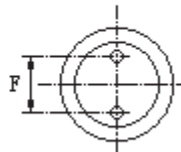
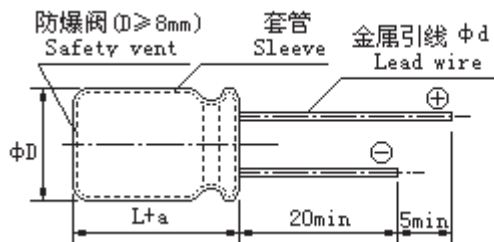

	mm			
ΦD ± 0.5	4	5	6.3	8
L	7	7	7	7
F ± 0.5	1.5	2.0	2.5	3.5
Φd ± 0.05	0.45			0.5
a	1.0			

## SS1, ST1 Series

■ 标称电容量、额定电压、额定纹波电流及外形尺寸对应表  
 Nominal capacitance, rated voltage, rated ripple current and case size table

$\mu F$ / WV / mA	6.3V 0J		10V 1A		16 1C		25V 1E		35V 1V		50V 1H		63V 1J	
	$\Phi D \times L$	I~mA	$\Phi D \times L$	I~mA	$\Phi D \times L$	I~mA	$\Phi D \times L$	I~mA	$\Phi D \times L$	I~mA	$\Phi D \times L$	I~mA	$\Phi D \times L$	I~mA
0.1 (0R1)											4 × 7	1.3	4 × 7	1.3
0.22 (R22)											4 × 7	3.0	4 × 7	3.0
0.33 (R33)											4 × 7	4.4	4 × 7	4.4
0.47 (R47)											4 × 7	6.3	4 × 7	6.3
1.0 (010)											4 × 7	12	4 × 7	12
2.2 (2R2)											4 × 7	16	4 × 7	16
3.3 (3R3)							4 × 7	18	4 × 7	18	4 × 7	19	4 × 7	21
4.7 (4R7)							4 × 7	21	4 × 7	22	4 × 7	24	5 × 7	26
10 (100)					4 × 7	28	4 × 7	31	4 × 7	30	5 × 7	42	6.3 × 7	45
22 (220)	4 × 7	34	4 × 7	38	4 × 7	42	5 × 7	55	5 × 7	55	6.3 × 7	64		
33 (330)	4 × 7	42	4 × 7	46	5 × 7	62	6.3 × 7	66	6.3 × 7	73	8 × 7	75		
47 (470)	4 × 7	50	5 × 7	66	5 × 7	73	6.3 × 7	80	8 × 7	95	8 × 7	85		
100 (101)	5 × 7	87	6.3 × 7	99	6.3 × 7	110	8 × 7	115	8 × 7	115				
220 (221)	6.3 × 7	133	8 × 7	165	8 × 7	145								
330 (331)	8 × 7	180	8 × 7	210										

I~ 额定纹波电流 Rated ripple current: (mA , 85/105°C, 120Hz)