

# TS011-S160B2H50C

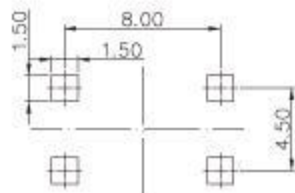

P.C.B焊接图  
P.C.B diagram

1. 额定功率:DC 12V 50mA ;  
(Rating)
2. 接触电阻:100mΩ Max ;  
(Contact Resistance)
3. 绝缘电阻:100MΩ Min ;  
(Insulation Resistance)
4. 动作力  
(Operating Force) :160±30gf;  
250±50gf;
5. 寿命 (Life) :50,000 cycles ;  
100,000 cycles ;  
200,000 cycles;
6. 行程 (Travel) :0.25±0.1mm 。
7. H值  
(H value) :4.3mm, 5.0mm, 6.0mm, 6.5mm,  
7.0mm, . . . . . 13.00mm, 13.50mm

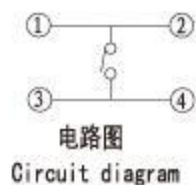
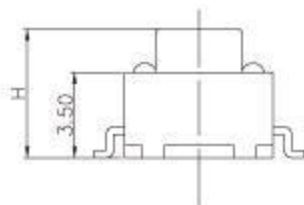
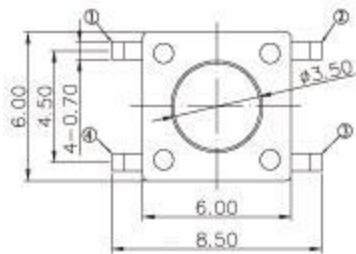
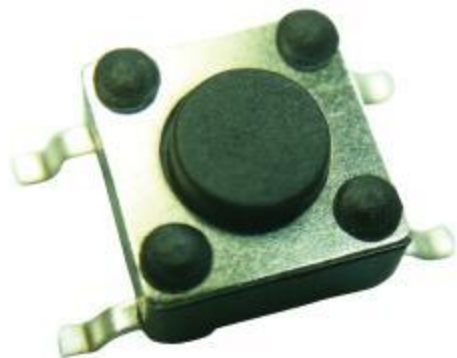