

Spring-loaded test probe

GKS-427 303 200 A 1502 M

Item GKS-427-0010



ingun[®]

Partner for Future Technology

INGUN SELECTION

- Short-stroke screw-in test probes for applications with possible vibrations or unwanted lateral and axial forces (migration of the test probes out of the receptacles is safely prevented)
- The screw-in test probe is securely installed in the KS using a torque screwdriver and bit tool. The required screw-in torque is applied via a square post on the receptacle.
- Stainless steel versions for temperatures from -100 °C up to +200 °C available

General data

Product group	Screw-in test probe
Sub-product group	Screw-in test probe
Series	GKS-427 M screw-in
Grid	2.54 mm [100 mil]
Contacting from	Pin, Post
Magnetic	Yes
Installation type	Screw-in
Quick-exchange system	Yes
Adjustable installation height	No
Non-rotating	No
Screw-in torque	3 - 5 cNm [.265 - .442 lbf·in]
Compatible receptacle(s)	KS-427 M
Min. temperature	- 40 °C [- 104 °F]
Max. temperature	+ 80 °C [+ 176 °F]
RoHS-compliant	RoHS-3;6c



1:1

Electrical data

Current load capacity / rated current	8 A
Typical resistance (Ri)	<20 mOhm

Mechanical data

Total length	19.5 mm [.767 in]
Barrel diameter	1.65 mm [.064 in]
Maximum stroke	4.5 mm [.177 in]
Spring pre-load	0.25 N [.899 ozf]
Collar height	02
Spring force at working stroke	1.5 N [5.39 ozf]
Recommended working stroke	3.5 mm [.137 in]

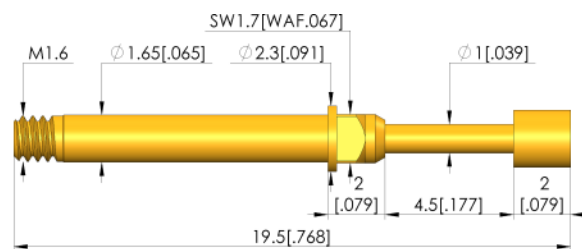

Tip style data

Tip style	03 inverse cone
Tip diameter	2 mm [.078 in]
Tip style surface	A gold
Tip style material	3 CuBe

Spring-loaded test probe
GKS-427 303 200 A 1502 M
Item GKS-427-0010

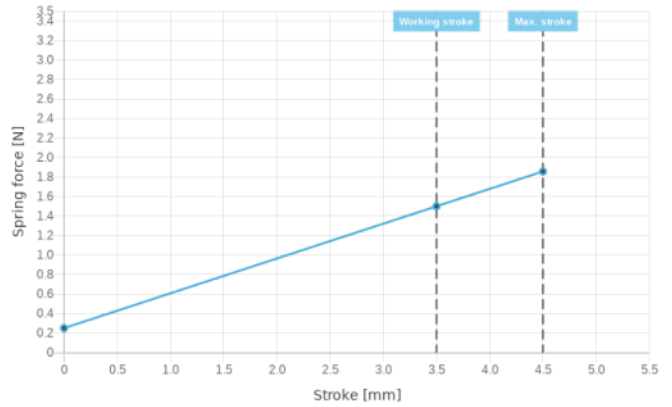
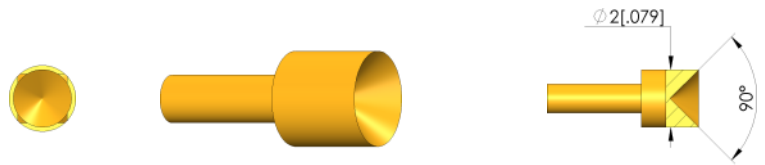

INGUN Prüfmittelbau GmbH

Max-Stromeyer-Straße 162
78467, Constance, Germany
Phone +49 7531 8105-0
Customer hotline +49 7531 8105-888
Fax +49 7531 8105-65
info@ingun.com



Prices and delivery times on request.
Technical changes reserved. 06/23 EN

Learn more about
Screw-in test probe

