

GQ

NEW P1~8

ONPOW

## 金属信号灯

METAL SIGNAL LAMP

6,8,10,12,14mm  
16,19,22,25mm



黄铜镀镍  
NICKEL-PLATED BRASS

不锈钢  
STAINLESS STEEL

黄铜镀黑  
BRASS(BLACK)

## Features

- ★ Installation size: 6/8/10/12/14/16/19/22/25mm
- ★ Lamp voltage: 6/12/24/110/220V
- ★ Shell material: nickel-plated brass/ black-plated brass / stainless steel
- ★ Connection: pin type / screw type /15mm wire
- ★ Head shape: a hemispherical head / flat head
- ★ Waterproof level: IP67.
- ★ Head shape and installation size can be customized

## GQ Series anti-vandal waterproof metal indicator

### Characteristic

GQ series indicator is a new series of anti-vandal indicator. Comparing with the normal one, this has different kinds of diameter, and they are easier to mount and look beautiful. GQ indicator is applied to small appliance, measuring apparatus, medical facility, vehicle and so on.

### Part-number Description

GQ	★	■	—	D	/	◆	/	△	/	▲	/	◎
Code of series	Mounting hole	The front shape	Lamp type	Connect type	Lamp color	Lamp voltage	Crust material					
	6 Φ6mm 8 Φ8mm 10 Φ10mm 12 Φ12mm 14 Φ14mm 16 Φ16mm 19 Φ19mm 22 Φ22mm 25 Φ25mm	G Domed T Flat round 1 F Flat round 2	D Dot	L Screw terminal Y About 15cm wire  No letter means screw terminal	R Red G Green Y Yellow O Orange B Blue W White N Black	AC/DC 6V AC/DC 12V AC/DC 24V AC/DC 110V AC/DC 220V	N Nickel-plated brass S Stainless steel A Black-plated brass					

Note: Please read the catalogue carefully, and choose the right part-number according to the sign.

### Lamp Ratings

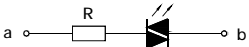
Lamp Type	LED lamp(AC/DC)
Lamp color	<span style="color:red">R</span> <span style="color:green">G</span> <span style="color:yellow">Y</span> <span style="color:orange">O</span> <span style="color:blue">B</span> <span style="border:1px solid black; padding:0 2px;">W</span>
Life	40000 hours(Reference)
Rated Voltage	AC/DC6V, AC/DC12V, AC/DC110V, AC/DC24V, AC/DC36V, AC/DC220V
Rated Current	2~15mA
Dropping Way	Inner resistance
Lamp	Using AC/DC LED lamp, the terminals have no difference
Circuit	of anode and cathode: Using inner resistance,
Diagram	do not need connect outer resistance 
Note: DC LED and other voltage can be made to order.	

### Standard

Standard  
EN61547-2000  
JB/T 8975-2006

### Specifications

Operating Temperature	-25℃~+55℃ keep the air flowing around indicator
Operating Humidity	45~85%RH(no condensation)
Insulation Resistance	≥1000MΩ
Dielectric Strength	1500V,A C50Hz,5 seconds
Vibration Resistance	50Hz,Amplitude 1.2mm
Shock Resistance	>10g
Solder Heat Resistance	320℃(or 30W soldering iron) no more than 2 seconds)



Nickel-plated brass  
GQ6T-D/Δ/▲/N



Black-plated brass  
GQ6T-D/Δ/▲/A



Stainless steel  
GQ6T-D/Δ/▲/S

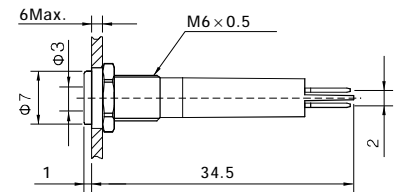

Nickel-plated brass  
GQ6T-D/Y/Δ/▲/N



Black-plated brass  
GQ6T-D/Y/Δ/▲/A



Stainless steel  
GQ6T-D/Y/Δ/▲/S

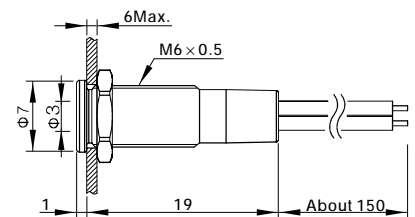

Nickel-plated brass  
GQ6G-D/Δ/▲/N



Black-plated brass  
GQ6G-D/Δ/▲/A



Stainless steel  
GQ6G-D/Δ/▲/S

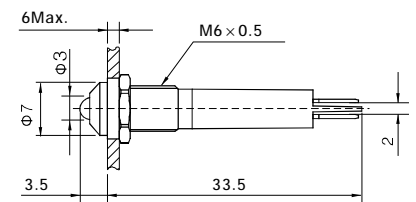

Nickel-plated brass  
GQ6G-D/Y/Δ/▲/N



Black-plated brass  
GQ6G-D/Y/Δ/▲/A



Stainless steel  
GQ6G-D/Y/Δ/▲/S

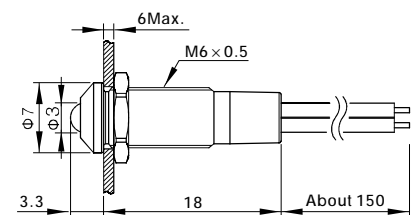

- ⊙ Lamo color ( Δ ) : **R G Y O B W**
- ⊙ Lamp voltage ( ▲ ) : 6V,12V,24V,110V,220V;
- ⊙ Mounting hole: Φ6mm
- ⊙ Lamp type: LED
- ⊙ Rated Current: 2mA ~ 20mA
- ⊙ Torque: About 0.1Nm
- ⊙ Panel Thickness: 1 ~ 6mm
- ⊙ Operating Temperature: -25℃~+55℃
- ⊙ Terminal Type: Pin terminal ( 2.8×0.5mm ) / About 15cm wire
- ⊙ Solder Heat Resistance: 320℃(or 30W soldering iron) no more than 2 seconds)
- ⊙ Crust material: Nickel-plated brass/Black-plated brass/stainless steel 303
- ⊙ Lamp cover material: Epoxy ( Anti-UV can be made to order )
- ⊙ Base material: PA
- ⊙ IP degree: IP67,IK10
- ⊙ **RoHS**

GQ6 Indicator  
Specification



Nickel-plated brass  
GQ8T-D/Δ/▲/N



Black-plated brass  
GQ8T-D/Δ/▲/A



Stainless steel  
GQ8T-D/Δ/▲/S

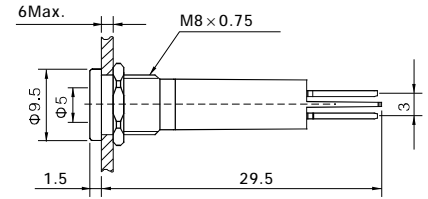

Nickel-plated brass  
GQ8T-D/Y/Δ/▲/N



Black-plated brass  
GQ8T-D/Y/Δ/▲/A



Stainless steel  
GQ8T-D/Y/Δ/▲/S

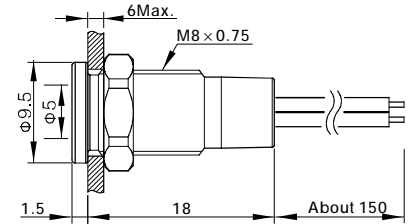

Nickel-plated brass  
GQ8G-D/Δ/▲/N



Black-plated brass  
GQ8G-D/Δ/▲/A



Stainless steel  
GQ8G-D/Δ/▲/S

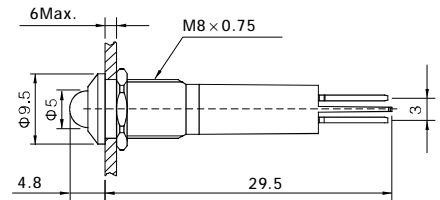

Nickel-plated brass  
GQ8G-D/Y/Δ/▲/N



Black-plated brass  
GQ8G-D/Y/Δ/▲/A



Stainless steel  
GQ8G-D/Y/Δ/▲/S

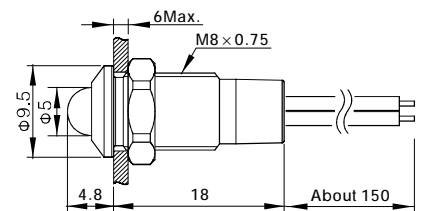

- ⊙ Lamo color ( Δ ) : R G Y O B W
- ⊙ Lamp voltage ( ▲ ) : 6V,12V,24V,110V,220V;
- ⊙ Mounting hole: Φ8mm
- ⊙ Lamp type: LED
- ⊙ Rated Current: 2mA ~ 20mA
- ⊙ Torque: About 0.2Nm
- ⊙ Panel Thickness: 1 ~ 6mm
- ⊙ Operating Temperature: -25°C ~ +55°C
- ⊙ Terminal Type: Pin terminal ( 2.8 × 0.8mm ) / About 15cm wire
- ⊙ Solder Heat Resistance: 320°C(or 30W soldering iron) no more than 2 seconds)
- ⊙ Crust material: Nickel-plated brass/Black-plated brass/stainless steel 303
- ⊙ Lamp cover material: Epoxy ( Anti-UV can be made to order )
- ⊙ Base material: PA
- ⊙ IP degree: IP67,IK10
- ⊙ RoHS

GQ8 Indicator  
Specification



Nickel-plated brass  
GQ8F-D/△/▲/N

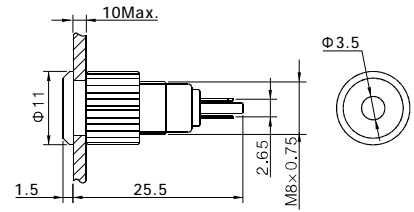

Nickel-plated brass  
GQ12F-D/△/▲/N

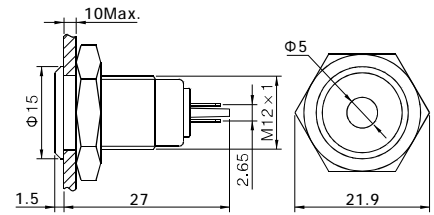

- ⊙ Lamp color ( △ ) : R G Y O B W
- ⊙ Lamp voltage ( ▲ ) : 6V, 12V, 24V, 110V, 220V;
- ⊙ Mounting hole:  $\Phi 8, 12\text{mm}$
- ⊙ Lamp type: LED
- ⊙ Rated Current: 2mA ~ 20mA
- ⊙ Torque: About 0.3Nm
- ⊙ Panel Thickness: 1 ~ 10mm
- ⊙ Operating Temperature:  $-25^{\circ}\text{C} \sim +55^{\circ}\text{C}$
- ⊙ Terminal Type: Pin terminal ( 1.8 × 0.4mm )
- ⊙ Solder Heat Resistance: 320°C (or 30W soldering iron) no more than 2 seconds)
- ⊙ Crust material: Nickel-plated brass/Black-plated brass/stainless steel
- ⊙ Lamp cover material: Epoxy ( Anti-UV can be made to order )
- ⊙ Base material: PA
- ⊙ IP degree: IP67, IK10
- ⊙ RoHS

GQ8, GQ12 Indicator  
Specification



Nickel-plated brass  
GQ10T-D/Δ/▲/N



Black-plated brass  
GQ10T-D/Δ/▲/A



Stainless steel  
GQ10T-D/Δ/▲/S

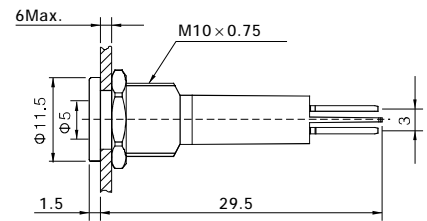

Nickel-plated brass  
GQ10T-D/Y/Δ/▲/N



Black-plated brass  
GQ10T-D/Y/Δ/▲/A



Stainless steel  
GQ10T-D/Y/Δ/▲/S

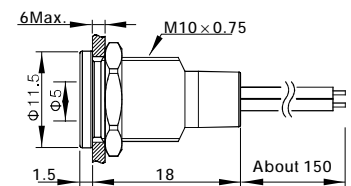

Nickel-plated brass  
GQ10G-D/Δ/▲/N



Black-plated brass  
GQ10G-D/Δ/▲/A



Stainless steel  
GQ10G-D/Δ/▲/S

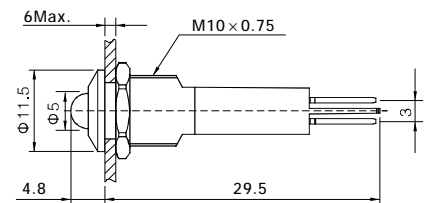

Nickel-plated brass  
GQ10G-D/Y/Δ/▲/N



Black-plated brass  
GQ10G-D/Y/Δ/▲/A



Stainless steel  
GQ10G-D/Y/Δ/▲/S

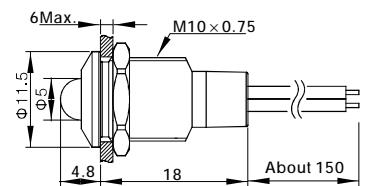

- ⊙ Lamp color ( Δ ) : **R** **G** **Y** **O** **B** **W**
- ⊙ Lamp voltage ( ▲ ) : 6V,12V,24V,110V,220V;
- ⊙ Mounting hole: Φ10mm
- ⊙ Lamp type: LED
- ⊙ Rated Current: 2mA ~ 20mA
- ⊙ Torque: About 0.3Nm
- ⊙ Panel Thickness: 1 ~ 6mm
- ⊙ Operating Temperature: -25°C ~ +55°C
- ⊙ Terminal Type: Pin terminal ( 2.8×0.5mm ) / About 15cm wire
- ⊙ Solder Heat Resistance: 320°C(or 30W soldering iron) no more than 2 seconds)
- ⊙ Crust material: Nickel-plated brass/Black-plated brass/stainless steel 303
- ⊙ Lamp cover material: Epoxy ( Anti-UV can be made to order )
- ⊙ Base material: PA
- ⊙ IP degree: IP67,IK10
- ⊙ **RoHS**

GQ10 Indicator  
Specification



Nickel-plated brass  
GQ12T-D/Δ/▲/N



Black-plated brass  
GQ12T-D/Δ/▲/A



Stainless Steel  
GQ12T-D/Δ/▲/S

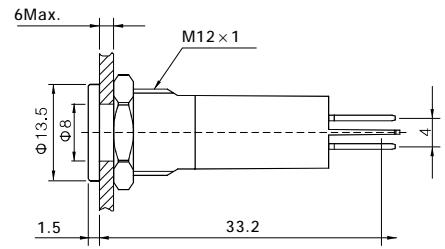

Nickel-plated brass  
GQ12T-D/Y/Δ/▲/N



Black-plated brass  
GQ12T-D/Y/Δ/▲/A



Stainless steel  
GQ12T-D/Y/Δ/▲/S

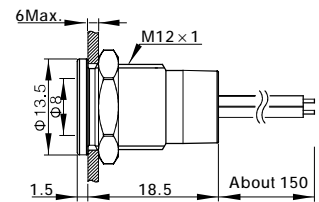

Nickel-plated brass  
GQ12G-D/Δ/▲/N



Black-plated brass  
GQ12G-D/Δ/▲/A



Stainless Steel  
GQ12G-D/Δ/▲/S

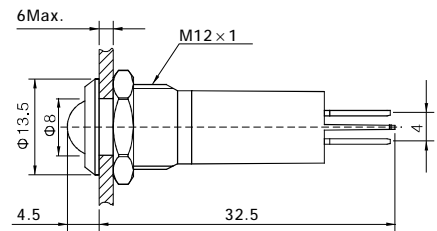

Nickel-plated brass  
GQ12G-D/Y/Δ/▲/N



Black-plated brass  
GQ12G-D/Y/Δ/▲/A



Stainless steel  
GQ12G-D/Y/Δ/▲/S

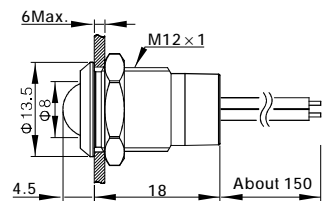

- ⊙ Lamo color ( Δ ) : **R G Y O B W**
- ⊙ Lamp voltage ( ▲ ) : 6V,12V,24V,110V,220V;
- ⊙ Mounting hole: Φ12mm
- ⊙ Lamp type: LED
- ⊙ Rated Current: 2mA ~ 20mA
- ⊙ Torque: About 0.3Nm
- ⊙ Panel Thickness: 1 ~ 6mm
- ⊙ Operating Temperature: -25°C ~ +55°C
- ⊙ Terminal Type: Pin terminal ( 2.8×0.5mm ) / About 15cm wire
- ⊙ Solder Heat Resistance: 320°C(or 30W soldering iron) no more than 2 seconds)
- ⊙ Crust material: Nickel-plated brass/Black-plated brass/stainless steel
- ⊙ Lamp cover material: Epoxy ( Anti-UV can be made to order )
- ⊙ Base material: PA
- ⊙ IP degree: IP67,IK10
- ⊙ **RoHS**

GQ12 Indicator  
Specification





Nickel-plated brass  
GQ14T-D/Δ/▲/N



Black-plated brass  
GQ14T-D/Δ/▲/A



Stainless Steel  
GQ14T-D/Δ/▲/S

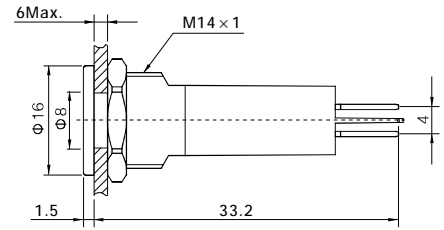

Nickel-plated brass  
GQ14T-D/Y/Δ/▲/N



Black-plated brass  
GQ14T-D/Y/Δ/▲/A



Stainless steel  
GQ14T-D/Y/Δ/▲/S

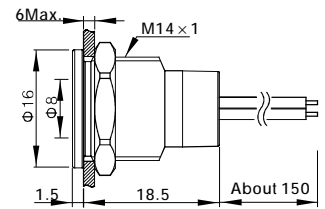

Nickel-plated brass  
GQ14G-D/Δ/▲/N



Black-plated brass  
GQ14G-D/Δ/▲/A



Stainless Steel  
GQ14G-D/Δ/▲/S

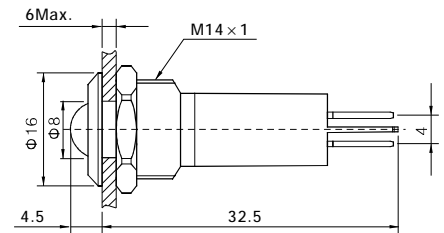

Nickel-plated brass  
GQ14G-D/Y/Δ/▲/N



Black-plated brass  
GQ14G-D/Y/Δ/▲/A



Stainless steel  
GQ14G-D/Y/Δ/▲/S

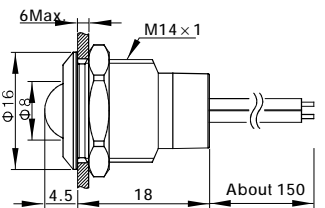

- ⊙ Lamo color ( Δ ) : R G Y O B W
- ⊙ Lamp voltage ( ▲ ) : 6V,12V,24V,110V,220V;
- ⊙ Mounting hole: Φ14mm
- ⊙ Lamp type: LED
- ⊙ Rated Current: 2mA ~ 20mA
- ⊙ Torque: About 0.4Nm
- ⊙ Panel Thickness: 1 ~ 6mm
- ⊙ Operating Temperature: -25°C ~ + 55°C
- ⊙ Terminal Type: Pin terminal ( 2.8×0.8mm ) / About 15cm wire
- ⊙ Solder Heat Resistance: 320°C(or 30W soldering iron) no more than 2 seconds)
- ⊙ Crust material: Nickel-plated brass/Black-plated brass/stainless steel
- ⊙ Lamp cover material: Epoxy ( Anti-UV can be made to order )
- ⊙ Base material: PA
- ⊙ IP degree: IP67,IK10
- ⊙ RoHS

GQ14 Indicator  
Specification





Nickel-plated brass  
GQ16T-D/Δ/▲/N



Black-plated brass  
GQ16T-D/Δ/▲/A



Stainless steel  
GQ16T-D/Δ/▲/S

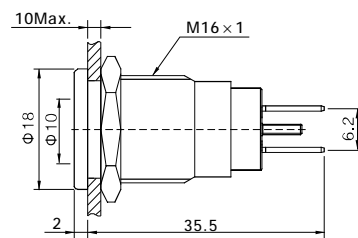

Nickel-plated brass  
GQ16G-D/Δ/▲/N



Black-plated brass  
GQ16G-D/Δ/▲/A



Stainless steel  
GQ16G-D/Δ/▲/S

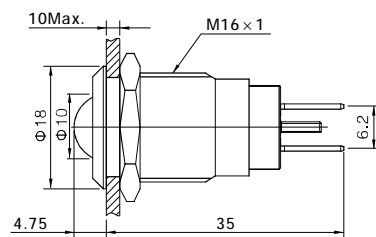

Nickel-plated brass  
GQ16T-D/L/Δ/▲/N



Black-plated brass  
GQ16T-D/L/Δ/▲/A



Stainless steel  
GQ16T-D/L/Δ/▲/S

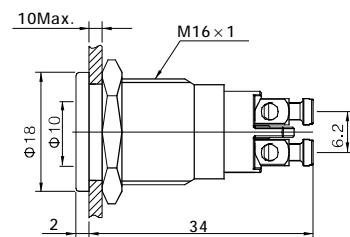

Nickel-plated brass  
GQ16G-D/L/Δ/▲/N



Black-plated brass  
GQ16G-D/L/Δ/▲/A



Stainless steel  
GQ16G-D/L/Δ/▲/S

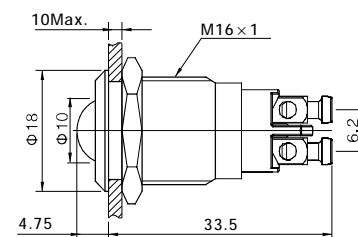

- ⊙ Lamo color ( Δ ) : R G Y O B W
- ⊙ Lamp voltage ( ▲ ) : 6V,12V,24V,110V,220V;
- ⊙ Mounting hole: Φ16mm
- ⊙ Lamp type: LED
- ⊙ Rated Current: 2mA~20mA
- ⊙ Torque: About 0.6Nm
- ⊙ Panel Thickness: 1~10mm
- ⊙ Operating Temperature: -25°C ~ +55°C
- ⊙ Terminal Type: Pin terminal ( 2.8×0.8mm ) / screw terminal
- ⊙ Solder Heat Resistance: 320°C(or 30W soldering iron) no more than 2 seconds)
- ⊙ Crust material: Nickel-plated brass/Black-plated brass/stainless steel
- ⊙ Lamp cover material: Epoxy ( Anti-UV can be made to order )
- ⊙ Base material: PA
- ⊙ IP degree: IP67,IK10
- ⊙ RoHS

GQ16 Indicator  
Specification



Nickel-plated brass  
GQ19T-D/Δ/▲/N



Black-plated brass  
GQ19T-D/Δ/▲/A



Stainless steel  
GQ19T-D/Δ/▲/S

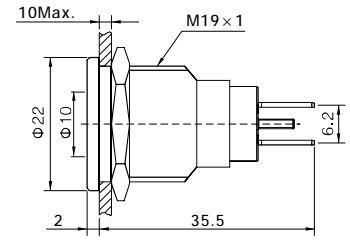

Nickel-plated brass  
GQ19G-D/Δ/▲/N



Black-plated brass  
GQ19G-D/Δ/▲/A



Stainless steel  
GQ19G-D/Δ/▲/S

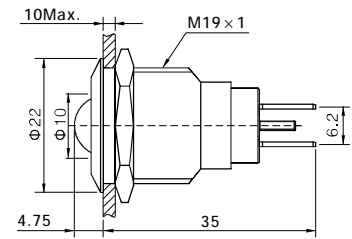

Nickel-plated brass  
GQ19T-D/L/Δ/▲/N



Black-plated brass  
GQ19T-D/L/Δ/▲/A



Stainless steel  
GQ19T-D/L/Δ/▲/S

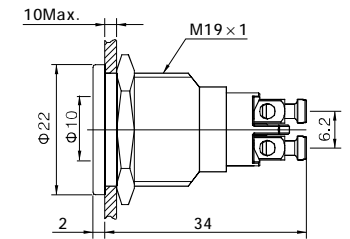

Nickel-plated brass  
GQ19G-D/L/Δ/▲/N



Black-plated brass  
GQ19G-D/L/Δ/▲/A



Stainless steel  
GQ19G-D/L/Δ/▲/S

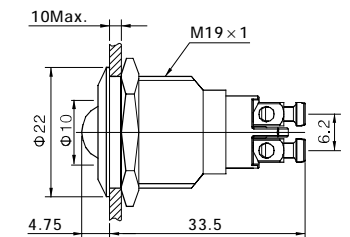

- ◎ Lamp color ( Δ ) : R G Y O B W
- ◎ Lamp voltage ( ▲ ) : 6V,12V,24V,110V,220V;
- ◎ Mounting hole: Φ19mm
- ◎ Lamp type: LED
- ◎ Rated Current: 2mA ~ 20mA
- ◎ Torque: About 0.8Nm
- ◎ Panel Thickness: 1 ~ 10mm
- ◎ Operating Temperature: -25°C ~ +55°C
- ◎ Terminal Type: Pin terminal ( 2.8×0.8mm ) / screw terminal
- ◎ Solder Heat Resistance: 320°C(or 30W soldering iron) no more than 2 seconds)
- ◎ Crust material: Nickel-plated brass/Black-plated brass/stainless steel
- ◎ Lamp cover material: Epoxy ( Anti-UV can be made to order )
- ◎ Base material: PA
- ◎ IP degree: IP67,IK10
- ◎ RoHS

GQ19 Indicator  
Specification



Nickel-plated brass  
GQ22T-D/Δ/▲/N



Black-plated brass  
GQ22T-D/Δ/▲/A



Stainless steel  
GQ22T-D/Δ/▲/S

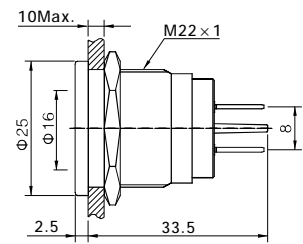

Nickel-plated brass  
GQ22G-D/Δ/▲/N



Black-plated brass  
GQ22G-D/Δ/▲/A



Stainless steel  
GQ22G-D/Δ/▲/S

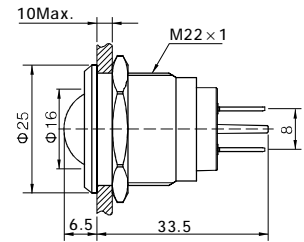

Nickel-plated brass  
GQ22T-D/L/Δ/▲/N



Black-plated brass  
GQ22T-D/L/Δ/▲/A



Stainless steel  
GQ22T-D/L/Δ/▲/S

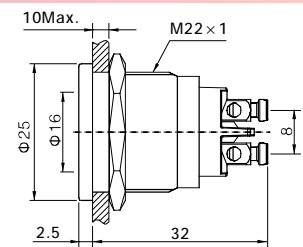

Nickel-plated brass  
GQ22G-D/L/Δ/▲/N



Black-plated brass  
GQ22G-D/L/Δ/▲/A



Stainless steel  
GQ22G-D/L/Δ/▲/S

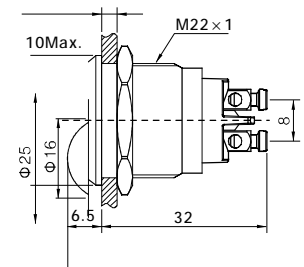

- ⊙ Lamp color ( Δ ) : **R** **G** **Y** **O** **B** **W**
- ⊙ Lamp voltage ( ▲ ) : 6V,12V,24V,110V,220V;
- ⊙ Mounting hole: Φ22mm
- ⊙ Lamp type: LED
- ⊙ Rated Current: 2mA ~ 20mA
- ⊙ Torque: About 1.2Nm
- ⊙ Panel Thickness: 1 ~ 10mm
- ⊙ Operating Temperature: -25°C ~ + 55°C
- ⊙ Terminal Type: Pin terminal ( 2.8×0.8mm ) / screw terminal
- ⊙ Solder Heat Resistance: 320°C(or 30W soldering iron) no more than 2 seconds)
- ⊙ Crust material: Nickel-plated brass/Black-plated brass/stainless steel
- ⊙ Lamp cover material: Epoxy ( Anti-UV can be made to order )
- ⊙ Base material: PA
- ⊙ IP degree: IP67,IK10
- ⊙ **RoHS** Made to order

GQ22 Indicator  
Specification



Nickel-plated brass  
GQ25T-D/Δ/▲/N



Black-plated brass  
GQ25T-D/Δ/▲/A



Stainless steel  
GQ25T-D/Δ/▲/S

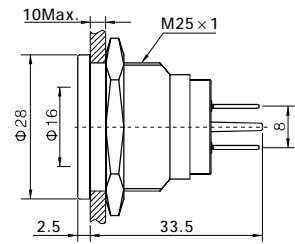

Nickel-plated brass  
GQ25G-D/Δ/▲/N



Black-plated brass  
GQ25G-D/Δ/▲/A



Stainless steel  
GQ25G-D/Δ/▲/S

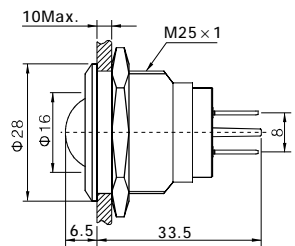

Nickel-plated brass  
GQ25T-D/L/Δ/▲/N



Black-plated brass  
GQ25T-D/L/Δ/▲/A



Stainless steel  
GQ25T-D/L/Δ/▲/S

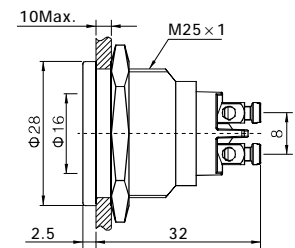

Nickel-plated brass  
GQ25G-D/L/Δ/▲/N



Black-plated brass  
GQ25G-D/L/Δ/▲/A



Stainless steel  
GQ25G-D/L/Δ/▲/S

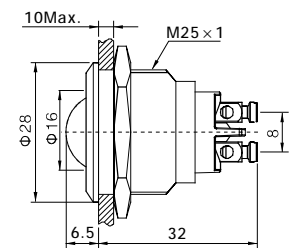

- ⊙ Lamp color ( Δ ) : **R** **G** **Y** **O** **B** **W**
- ⊙ Lamp voltage ( ▲ ) : 6V,12V,24V,110V,220V;
- ⊙ Mounting hole: Φ25mm
- ⊙ Lamp type: LED
- ⊙ Rated Current: 2mA ~ 20mA
- ⊙ Torque: About 1.2Nm
- ⊙ Panel Thickness: 1 ~ 10mm
- ⊙ Operating Temperature: -25°C ~ +55°C
- ⊙ Terminal Type: Pin terminal ( 2.8×0.8mm ) / screw terminal
- ⊙ Solder Heat Resistance: 320°C(or 30W soldering iron) no more than 2 seconds)
- ⊙ Crust material: Nickel-plated brass/Black-plated brass/stainless steel
- ⊙ Lamp cover material: Epoxy ( Anti-UV can be made to order )
- ⊙ Base material: PA
- ⊙ IP degree: IP67,IK10
- ⊙ **RoHS** Made to order

GQ25 Indicator  
Specification

# GQ8T TRI-COLOR INDICATOR

Flat Front+Wire terminal+Tri-color LED

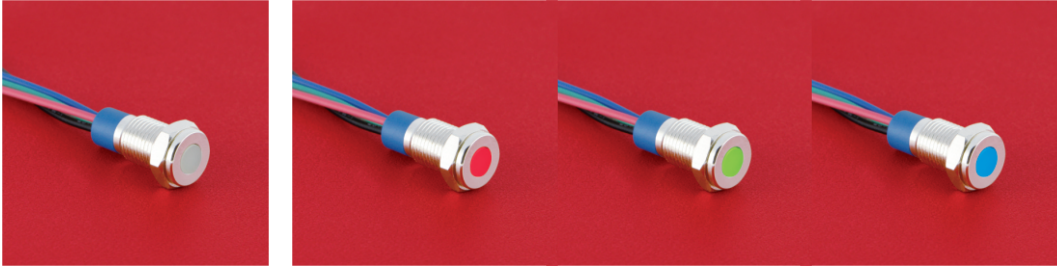

GQ8T-D/Y/★RGB/▲/◎  
(Dual color with 3 wires is available)

Tri-color Display

- LED Options★:
- 41 Tri-color (Common Cathode)
  - 42 Tri-color (Common Anode)
- LED Voltage▲ :
- AC/DC 6V
  - AC/DC 12V
  - AC/DC 24V
- Body◎ :
- N Nickel plated brass
  - S Stainless steel
  - A Black plated brass

## Specifications

- Panel Cutout:  $\Phi 8\text{mm}$
- Lamp Type: LED
- Rated current:  $2\text{mA} \sim 20\text{mA}$
- Torque: About  $0.1\text{Nm}$
- Panel Thickness:  $1 \sim 6\text{mm}$
- Terminal: Wires (About  $4\text{cm}$ )
- Body: Nickel plated brass/Black plated brass  
/303 Stainless steel
- Lamp Material: Epoxy (UV resistant can be customized)
- Base: PA
- Protection Class: IP67, IK10  
Compliant

RoHS

## Dimension

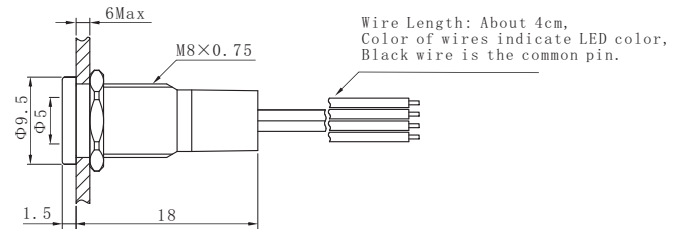

## Performance Characteristic

Operating Temperature	-25°C~+55°C (no freezing) Keep the air flowing
Operating Humidity	45~85%RH (Non condensing)
Insulation Resistance	$\geq 1000\text{M}\Omega$
Max. withstanding voltage	1500V, AC50Hz, 60s
Vibration resistance	50Hz, amplitude about 1.2mm
Shock resistance	$> 10\text{g}$
Solder resistance	320°C (or 30W soldering iron) no more than 2s

## Tri-color Lamp Specification

Lamp Type	Unidirection Tri-color LED
LED Color	<span style="color: red;">R</span> <span style="color: green;">G</span> <span style="color: blue;">B</span>
Life	40000hours (Reference)
Rated Voltage	Without Resistor: 1.8V, <span style="color: red;">R</span> , 2GV, <span style="color: blue;">B</span> 2.8V With internal resistor: DC6V, DC12V, DC24V
Rated Current	5~15mA
Lamp Circuit Diagram	<p>Common Cathode      Common Anode</p> <p>Using unidirection LED lamp, need distinguish anode and cathode, Using inner resistor, do not need connect outer resistor. (Three resistors need connected outside)</p>



# GQ8G TRI-COLOR INDICATOR

Domed Front+Wire terminal+Tri-color LED

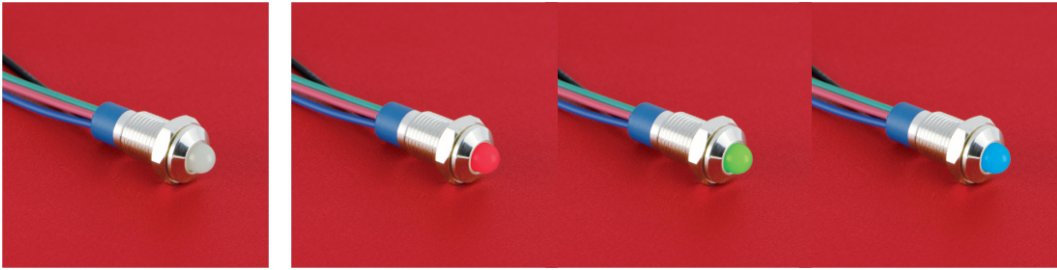

GQ8G-D/Y/★RGB/▲/◎  
(Dual color with 3 wires is available)

Tri-color Display

- LED Options★:  
 41 Tri-color (Common Cathode)  
 42 Tri-color (Common Anode)
- LED Voltage▲ :  
 AC/DC 6V  
 AC/DC 12V  
 AC/DC 24V
- Body◎ :  
 N Nickel plated brass  
 S Stainless steel  
 A Black plated brass

## Specifications

- Panel Cutout:  $\Phi 8\text{mm}$
- Lamp Type: LED
- Rated current:  $2\text{mA} \sim 20\text{mA}$
- Torque: About  $0.1\text{Nm}$
- Panel Thickness:  $1 \sim 6\text{mm}$
- Terminal: Wires (About  $4\text{cm}$ )
- Body: Nickel plated brass/Black plated brass  
/303 Stainless steel
- Lamp Material: Epoxy (UV resistant can be customized)
- Base: PA
- Protection Class: IP67, IK10  
Compliant

RoHS

## Dimension

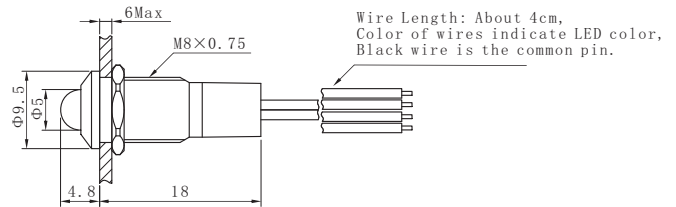

## Performance Characteristic

Operating Temperature	-25°C~+55°C (no freezing) Keep the air flowing
Operating Humidity	45~85%RH (Non condensing)
Insulation Resistance	$\geq 1000\text{M}\Omega$
Max. withstanding voltage	1500V, AC50Hz, 60s
Vibration resistance	50Hz, amplitude about 1.2mm
Shock resistance	>10g
Solder resistance	320°C (or 30W soldering iron) no more than 2s

## Tri-color Lamp Specification

Lamp Type	Unidirection Tri-color LED
LED Color	R G B
Life	40000hours (Reference)
Rated Voltage	Without Resistor: 1.8V, R, 2.0V, G, 2.8V, B With internal resistor: DC6V, DC12V, DC24V
Rated Current	5~15mA
Lamp Circuit Diagram	<p>Common Cathode</p> <p>Common Anode</p> <p>Using unidirection LED lamp, need distinguish anode and cathode, Using inner resistor, do not need connect outer resistor. (Three resistors need connected outside)</p>

# GQ12G TRI-COLOR INDICATOR

Domed Front+Wire terminal+Tri-color LED

**ONPOW**  
欧宝龙

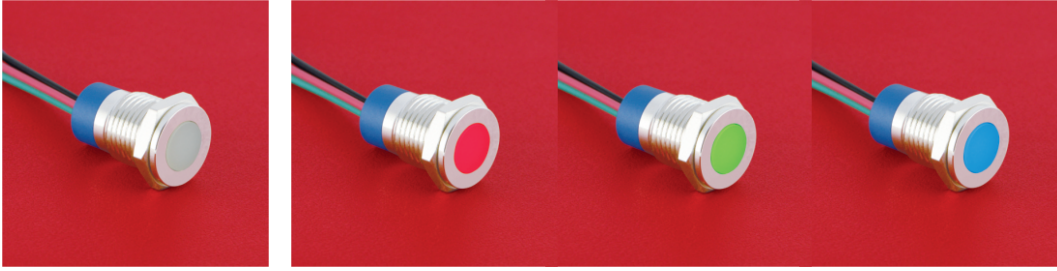

GQ12T-D/Y/★RGB/▲/◎  
(Dual color with 3 wires is available)

Tri-color Display

- LED Options★:  
 41 Tri-color (Common Cathode)  
 42 Tri-color (Common Anode)
- LED Voltage▲ :  
 AC/DC 6V  
 AC/DC 12V  
 AC/DC 24V
- Body◎ :  
 N Nickel plated brass  
 S Stainless steel  
 A Black plated brass

## Specifications

Panel Cutout:  $\Phi 12\text{mm}$   
 Lamp Type: LED  
 Rated current:  $2\text{mA} \sim 20\text{mA}$   
 Torque: About  $0.3\text{Nm}$   
 Panel Thickness:  $1 \sim 6\text{mm}$   
 Terminal: Wires (About  $4\text{cm}$ )

Body: Nickel plated brass/Black plated brass/303 Stainless steel  
 Lamp Material: Epoxy (UV resistant can be customized)  
 Base: PA  
 Protection Class: IP67, IK10  
 Compliant

RoHS

## Dimension

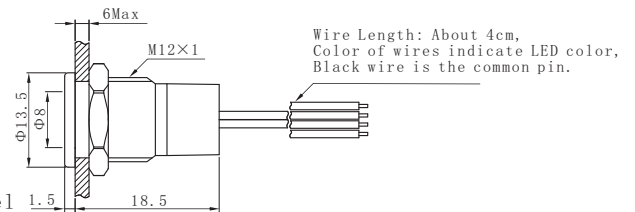

## Performance Characteristic

Operating Temperature	$-25^{\circ}\text{C} \sim +55^{\circ}\text{C}$ (no freezing) Keep the air flowing
Operating Humidity	$45 \sim 85\% \text{RH}$ (Non condensing)
Insulation Resistance	$\geq 1000\text{M}\Omega$
Max. withstanding voltage	$1500\text{V}$ , AC50Hz, 60s
Vibration resistance	50Hz, amplitude about $1.2\text{mm}$
Shock resistance	$> 10\text{g}$
Solder resistance	$320^{\circ}\text{C}$ (or $30\text{W}$ soldering iron) no more than 2s

## Tri-color Lamp Specification

Lamp Type	Unidirection Tri-color LED
LED Color	<b>R</b> <b>G</b> <b>B</b>
Life	40000hours (Reference)
Rated Voltage	Without Resistor: $1.8\text{V}$ , <b>R</b> , $2\text{GV}$ , <b>B</b> $2.8\text{V}$ With internal resistor: DC6V, DC12V, DC24V
Rated Current	$5 \sim 15\text{mA}$
Lamp Circuit Diagram	<p>Common Cathode      Common Anode</p> <p>Using unidirection LED lamp, need distinguish anode and cathode, Using inner resistor, do not need connect outer resistor. (Three resistors need connected outside)</p>



# GQ12T TRI-COLOR INDICATOR

Flat Front+Wire terminal+Tri-color LED

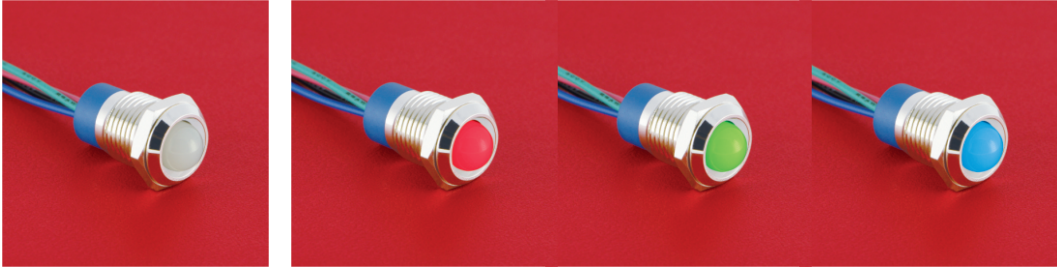

GQ12G-D/Y/★RGB/▲/◎  
(Dual color with 3 wires is available)

Tri-color Display

- LED Options★:  
 41 Tri-color (Common Cathode)  
 42 Tri-color (Common Anode)  
 LED Voltage▲ :  
 AC/DC 6V  
 AC/DC 12V  
 AC/DC 24V  
 Body◎ :  
 N Nickel plated brass  
 S Stainless steel  
 A Black plated brass

## Specifications

Panel Cutout:  $\Phi 12\text{mm}$   
 Lamp Type: LED  
 Rated current:  $2\text{mA} \sim 20\text{mA}$   
 Torque: About  $0.3\text{Nm}$   
 Panel Thickness:  $1 \sim 6\text{mm}$   
 Terminal: Wires (About  $4\text{cm}$ )

Body: Nickel plated brass/Black plated brass/303 Stainless steel  
 Lamp Material: Epoxy (UV resistant can be customized)  
 Base: PA  
 Protection Class: IP67, IK10  
 Compliant

RoHS

## Dimension

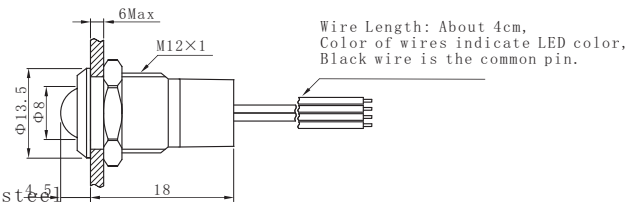

## Performance Characteristic

Operating Temperature	$-25^{\circ}\text{C} \sim +55^{\circ}\text{C}$ (no freezing) Keep the air flowing
Operating Humidity	$45 \sim 85\% \text{RH}$ (Non condensing)
Insulation Resistance	$\geq 1000\text{M}\Omega$
Max. withstanding voltage	$1500\text{V}$ , AC50Hz, 60s
Vibration resistance	$50\text{Hz}$ , amplitude about $1.2\text{mm}$
Shock resistance	$> 10\text{g}$
Solder resistance	$320^{\circ}\text{C}$ (or $30\text{W}$ soldering iron) no more than 2s

## Tri-color Lamp Specification

Lamp Type	Unidirection Tri-color LED
LED Color	<b>R</b> <b>G</b> <b>B</b>
Life	40000hours (Reference)
Rated Voltage	Without Resistor: $1.8\text{V}$ , <b>R</b> , $2\text{V}$ , <b>G</b> , $2.8\text{V}$ , <b>B</b> With internal resistor: DC6V, DC12V, DC24V
Rated Current	$5 \sim 15\text{mA}$
Lamp Circuit Diagram	<p>Common Cathode      Common Anode</p> <p>Using unidirection LED lamp, need distinguish anode and cathode, Using inner resistor, do not need connect outer resistor. (Three resistors need connected outside)</p>