

REVISION RECORD				
REV	ECN	DESCRIPTION	DRFT	DATE

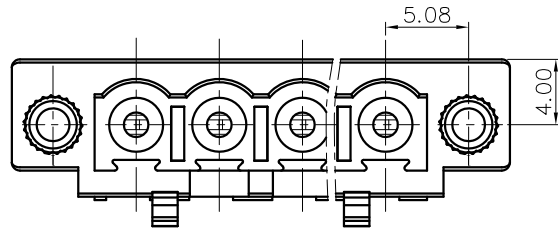

NOTES1:
 UL Standard
 1. Rated voltage/current : 300V / 15A
 2. Withstanding voltage : AC1600V/1Min.

IEC Standard

1. Pollution degree	2
Overvoltage category	III
Rate impulse voltage(KV)	4.0KV
Rate voltage(V)	320V
Rate current(A)	20A

NOTES2:

1. Dimension shall be interpreted per ASME Y14.5-2009
2. Pitch : 5.08mm, Poles : N=02~24P
3. Operating temperature: -40°C~+105°C
4. Undimensioned tolerances:

Pitch Range In mm		Nominal Dimension Range In mm					□	○	∠
TO	Over TO	Over TO	Over TO	Over TO	Over TO	0.1/10			
6	6 TO 10	10 TO 24	30 TO 60	60 TO 100	100 TO 150	150			
	±0.15	±0.20	±0.30	±0.30	±0.50	±0.70	±1.00	±1.30	
								±2'	

5. RoHS Compliance

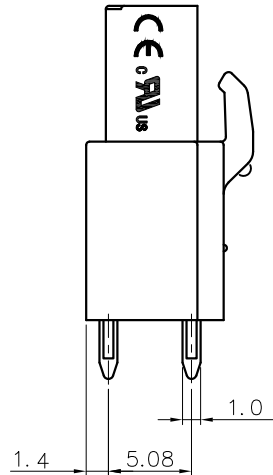
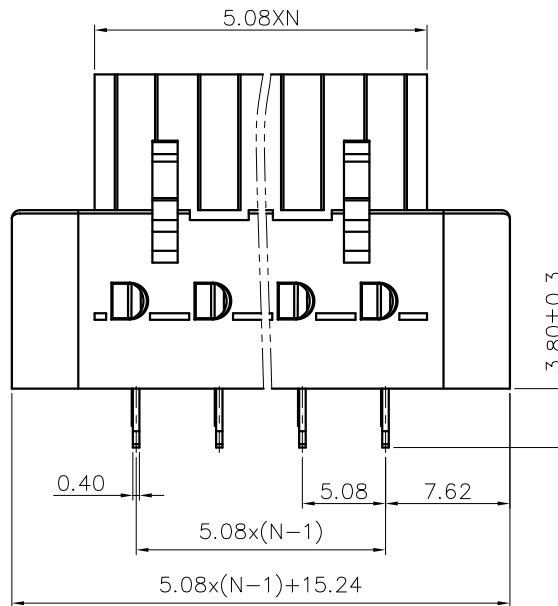
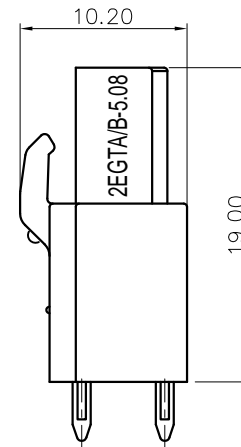

2EGTBM - 5.08 - XXP - 1Y - 00A H
 (Series No.) (Pitch) (Poles) (Single Pitch) (Color): 1.(Grey) 2.(Blue) 3.(Black) 4.(Green) 5.(Orange) 6.(Red) 7.(Transparent) 8.(Yellow) 9.(White)

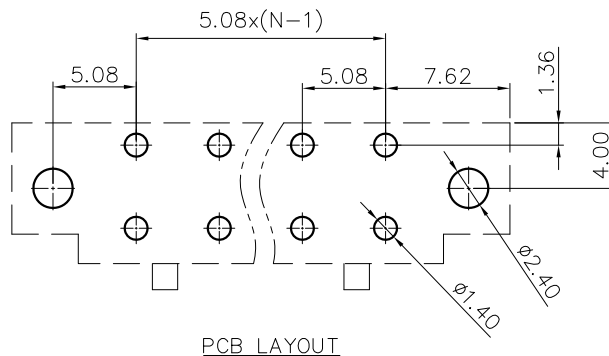

DETACHED LISTS	PART NO.:	Eric / 08/15/18'			
	APPD:	/			
	CHKD:	/			
	DRFT:	/			
	NAME:	2EGTBM-5.08-XXP-1Y-00AH			
	TITLE:	CUSTOMER DRAWING	REV	D0	
	DRAWING NO.:	/	SHEET	1/1	
	THIRD ANGLE PROJECTION	MM (INCH)	DO NOT SCALE DRAWING	SCALE	1:1