

↓ C0551-XXMBA(A,B)XBR

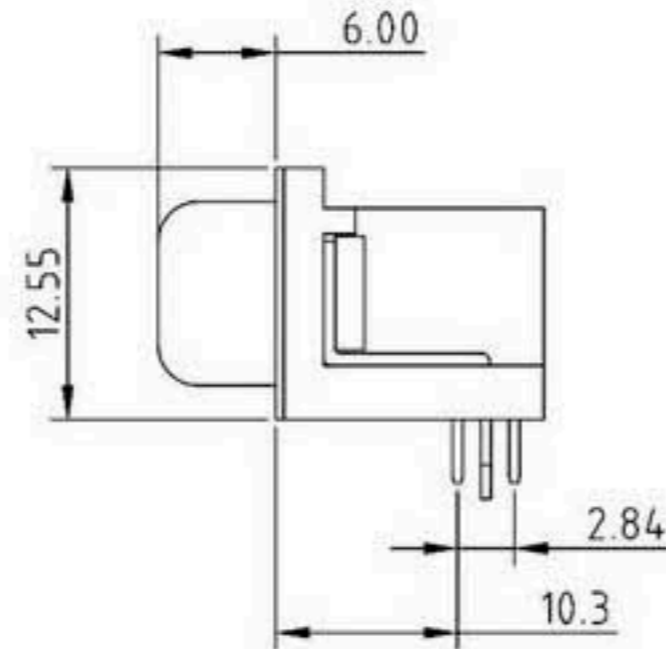

**ELECTRICAL CHARACTERISTICS**

Contact Current Rating: 3Amperes.  
 Dielectric Withstanding Voltage: AC 500V at sea level.  
 Insulation Resistance: 1000Megohms Min.  
 Contact Resistance: 30Milliohms Max.  
 Operation Temperature: -55°C to +105°C.

**Material**

Contact: Copper Alloy.  
 Insulator: PBT.  
 Shell: SPCC.  
 Z-Piece: Fe.  
 Screw: Copper Alloy.  
 Rivet: Copper Alloy. or Zinc.

**Note:**

No.	A	B	C
09	16.92	24.99	30.81
15	25.25	33.32	39.14
25	38.96	47.04	53.04
37	55.42	63.50	69.32

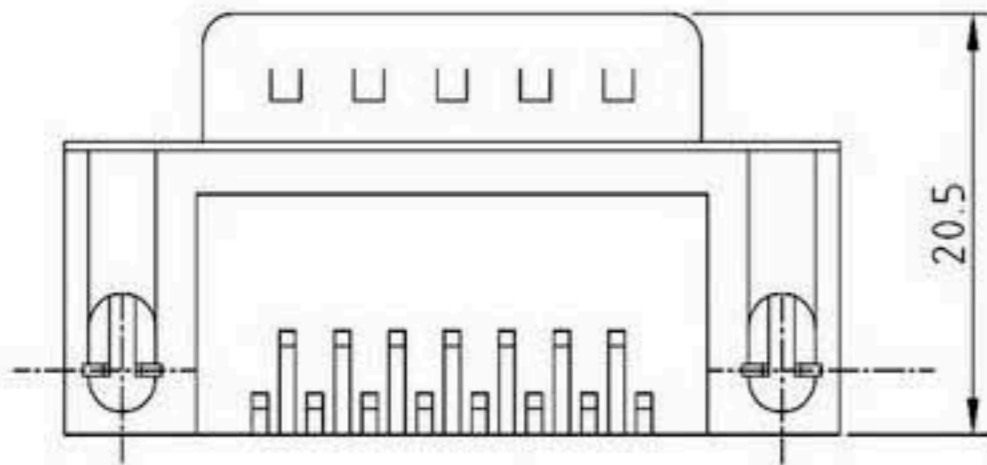

C0551-XXMA(C,E)(A,B)XBR

MOUNTING OPTION:  
 A: Boardlock(Z-Shape)

ACCESSORIES:  
 C: Fix Screws(4.8\*11.8)  
 E: Fix Screws(5.8\*12.0)

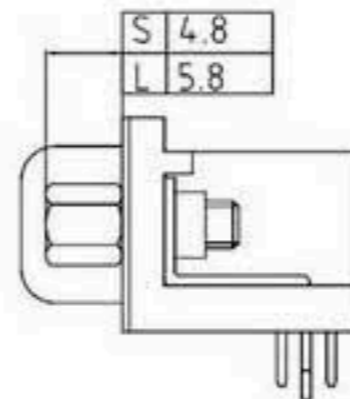

C0551-XXMB(C,E)(A,B)XBR

MOUNTING OPTION:  
 B: Rive W/Boardlock(Z-Shape)

ACCESSORIES:  
 C: Fix Screws(4.8\*11.8)  
 E: Fix Screws(5.8\*12.0)

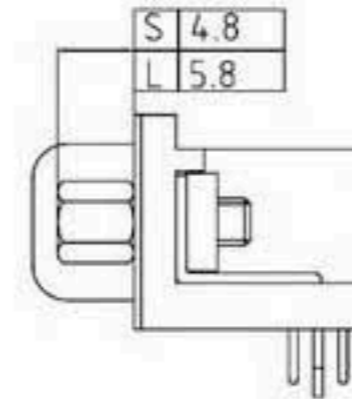

C0551-XXMB(B,D)(A,B)XBR

MOUNTING OPTION:  
 B: Rive W/Boardlock(Z-Shape)

ACCESSORIES:  
 B: ADD Screws(4.8\*11.8)  
 D: ADD Screws(5.8\*12.0)

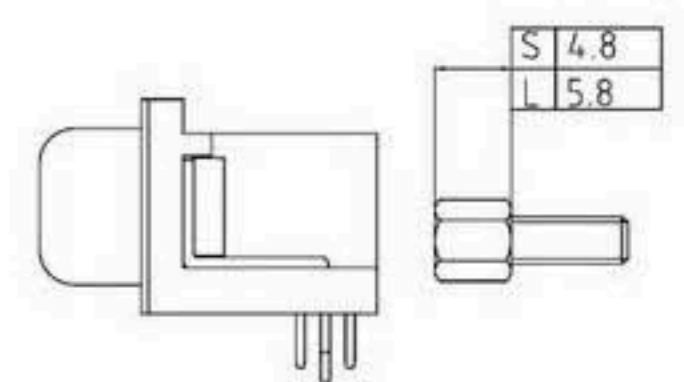

**Recommend PCB Layout**

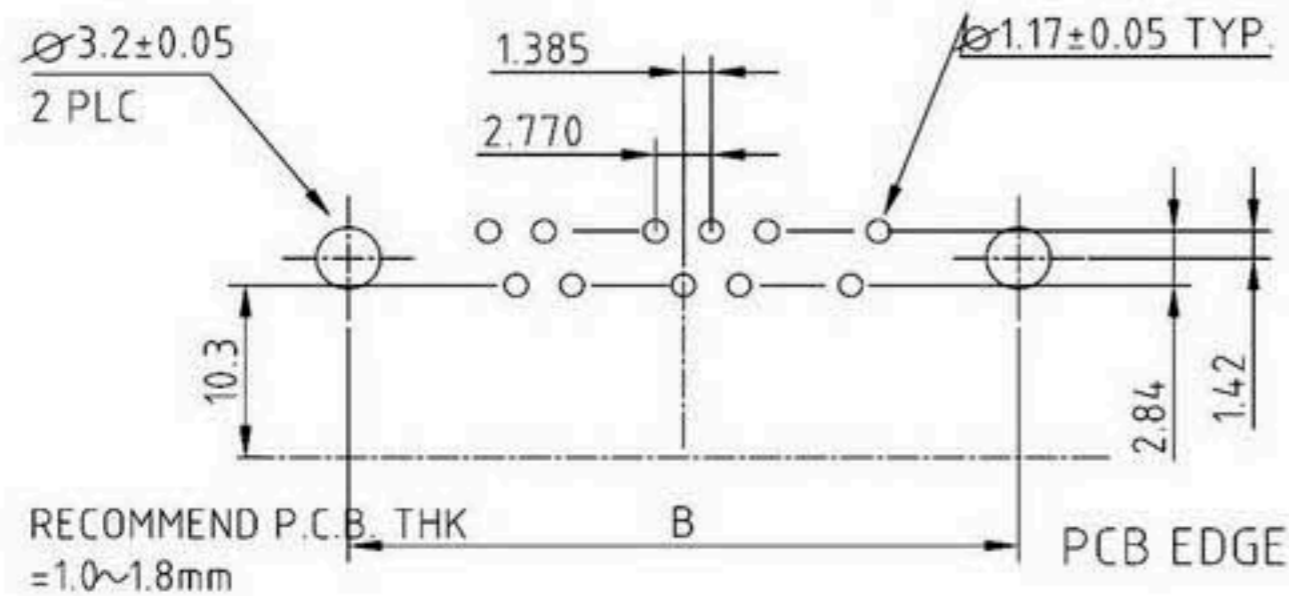

<p>RoHS Compliant</p>		<p><b>HSM</b> 玄茂科技股份有限公司          HSUAN MAO TECHNOLOGY CO., LTD.</p>	
<p>APPD. 核准</p>		<p>TOLERANCE 容許公差</p> <p>.0 ± 0.3          .00 ± 0.25          ANG. ± 2°</p>	<p>PART NAME 品名</p> <p>D-SUB PCB RIGHT ANGLE 9.4mm STAMPED PIN          XXP BLACK INSULATOR ROHS</p>
<p>DWG. 製圖</p> <p>Helen</p>	<p>SCALE 比例</p> <p>參考</p>	<p>UNIT 單位</p> <p>MM</p>	<p>PART NO. 料號</p> <p>C0551-XXMXXXXBR</p>
<p>DATE 制表日</p> <p>2012/3/16</p>	<p>PAGE 張數</p> <p>1 OF 1</p>	<p>SIZE 紙張尺寸</p> <p>A4</p>	<p>REV. 版本</p> <p>A</p>