

REV	DATE	DESCRIPTION
B	2017/07/07	增加 PCB LAYOUT

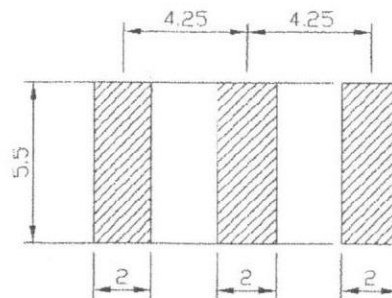
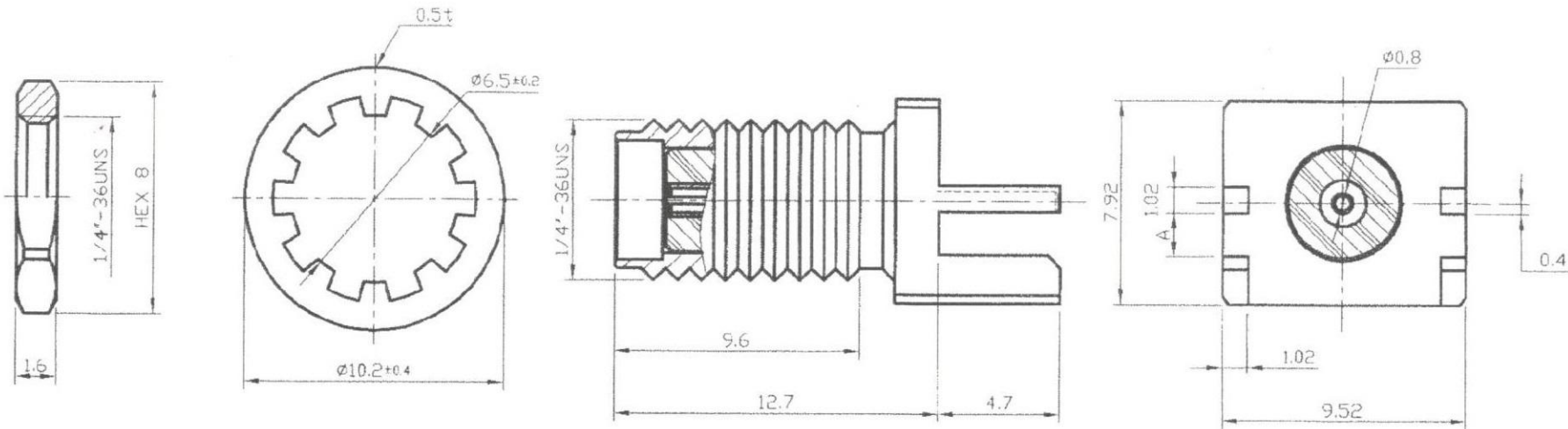

REFERENCE
P.C.H LAYOUT

A
1.0 mm
1.2 mm
1.7 mm
2.03 mm

05	NUT	BRASS	1	GOLD	
04	WASHER	BRASS	1	GOLD	
03	INSULATOR	TEFLON	1		
02	CENTER PIN	PHOSPHOR BRONZE	1	GOLD	
01	BODY	BRASS	1	GOLD	
NO	DESCRIPTION	MATERIAL	Q'TY	FINISH	ITEM

R&D	
APPROVED	
TOLERANCES	±0.1
SCALE	4:1
P/N	SMA909
TITLE	SMA Jack For End Launch Type
REV	B
	
RoHS COMPLIANT	
UNIT WEIGHT: 3.1 g	